

CBLS

COMPRESSION LOAD CELLS - LOW PROFILE

LAUMAS®
ELETTRONICA



Manufactured according to OIML R60 standards

Capacity from 200000 kg to 750000 kg



- 17-4 PH STAINLESS STEEL
- COMBINED ERROR $\leq \pm 0.10\%$
- PROTECTION CLASS IP68

CAPACITY	kg			EAC	NET WEIGHT OF LOAD CELL (kg)	CODE
200000		•	•	•	20	CBLS200000
300000		•	•	•	42	CBLS300000
500000		•	•	•	60	CBLS500000
750000		•	•	•	60	CBLS750000

ON REQUEST

CERTIFICATIONS

CERTIFICATIONS ON REQUEST

	Calibration report (ACCREDIA LAT traceability)
	ATEX II 1GD (zone 0-1-2-20-21-22)
	IECEx (zone 0-1-2-20-21-22)
	Complies with the Eurasian Custom Union regulations (Russia, Belarus, Kazakhstan)

OPTIONS ON REQUEST

DESCRIPTION



Two redundant strain gauges Wheatstone bridges (350 Ω) with two output cables; for dual safety systems

COMPLEMENTARY ACCESSORIES

DESCRIPTION	CODE	
<p>Upper plate.</p>	<p>Dimensions:</p> <p>Maximum static load:</p>	
	<p>Ø119 mm; h=60 mm</p> <p>200000 kg</p>	BOTTONE200
	<p>Ø198 mm; h=60 mm</p> <p>300000 kg</p>	BOTTONE
<p>Ø198 mm; h=89 mm</p> <p>500000 - 750000 kg</p>	BOTTONE750	

DIMENSIONS (mm)

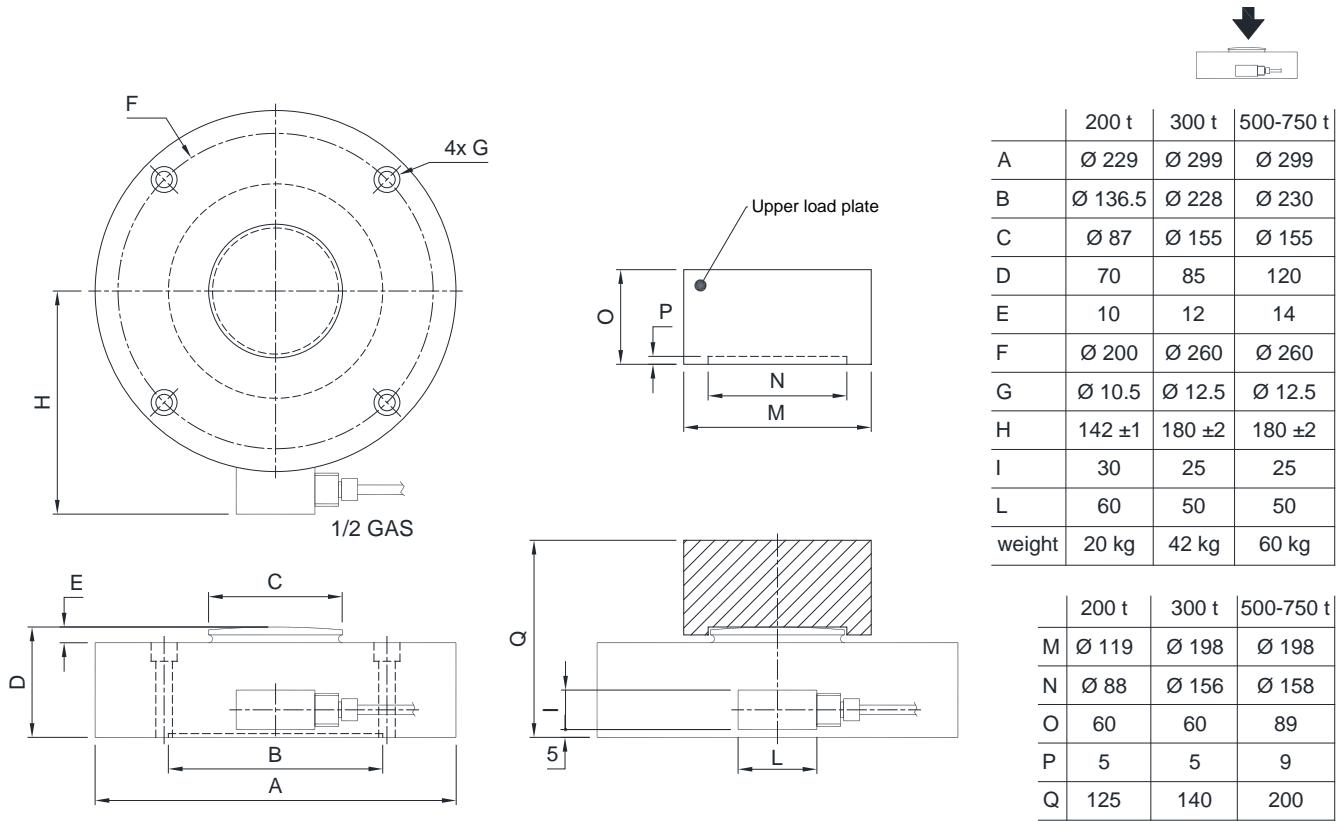

TECHNICAL FEATURES

Material	17-4 PH stainless steel		
Nominal load (E max)	200000 - 300000 - 500000 - 750000 kg		
Combined error	≤ ±0.10%		
Protection class	IP68		
Rated output	2 mV/V ±0.1%	Input resistance	700 Ω ±20
Temperature effect on zero	0.005% °C	Output resistance	700 Ω ±5
Temperature effect on span	0.005% °C	Zero balance	±1%
Compensated temperature range	-10 °C / +50 °C	Insulation resistance	>5000 MΩ
Operating temperature range	-20 °C / +70 °C	Safe overload (% of full scale)	150%
Creep at nominal load in 30 minutes	0.03%	Ultimate overload (% of full scale)	300%
Max supply voltage without damage	15 V	Deflection at nominal load	0.4 mm

ELECTRICAL CONNECTIONS

Cable length	10 m
Cable diameter	5 mm
Cores	4 x 0.25 mm ² /6 x 0.14 mm ²

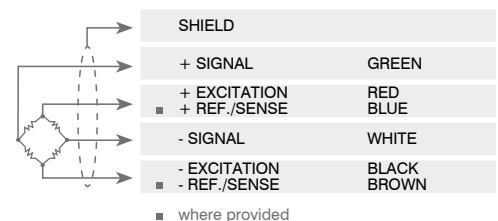

The Company reserves the right to make changes to the technical data, drawings and images without notice.